

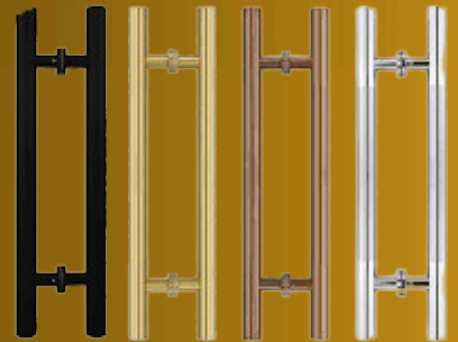

German Technology <sup>TM</sup>

# GLASSEXCEL

*architecture hardware*





is always striving to ensure customer satisfaction by providing the market place with high quality products at competitive pricing. Our specialty hardware, through thoughtful consideration is esigned to meet the needs of almost all of our customers design requirements while maintaining real world functionality. Upholding these high standards allow our firm to establish lasting relationships with our clients, whether you are building your own home or a grand development. It is our goal to exceed your expectations.



# Table of Content

01	Floor Spring	12	Canopy Fitting
02	Combo Patch Set	13	Profile Telescopic Sliding System
02	Hydraulic Patch	14	Profile Synchronized Sliding System
03-04	Patch Fitting	14	Profile Telescopic Sliding System Acc.
05	Glass Connectors	15	Spider Fitting
06	Shower Hinges	16	Fin Plates, Splice Plates, Routels
07	Plastic Profiles	17-18	Door Handles
07	Shower Knight Head Acc.	18	Shower Door Handles, Door Knobs
08	Shower Sliding System	19	Glass Railing Acc.
08	Sliding Door System	19	Aluminium Glazing Profile
09	Office Sliding System Set & Acc.	19	Profile Fixed Profile, Mini Hinges
10	Sliding Door Track	20	SS Friction Stay Hinge
10	Jaguar Sliding System	20	Aluminium Door Handle
10	Automatic Sliding Sensor Door	20	Self Taping Screw, Vacuum Lifter
11	Sliding Folding System	20	Double Sided Structural Glazing Tape
11	Center Sliding Folding System	20	Door Closer
12	Locks Without Cutout	20	Masking Tape



# Floor Spring

**TESTED TO 1000000 CYCLES**

## Solid Spring



**DFS-8400**  
Double Spring Floor Hinge

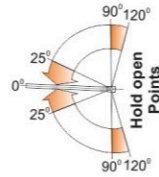
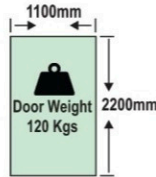

- Specification**
- Ove 10,00,000 cycles tested.
  - General design, suitable for left or right hand to open the door in single and both sides.
  - Universal machine cylinder.
  - Closing force-25nm.
  - Maximum wide door Size-1100x2200mm.
  - Maximum door weight-120kgs
  - Speed covering control-two stage adjustable speed.
  - Location-90° hold open

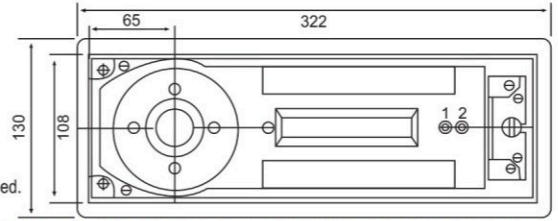

**TESTED TO 500000 CYCLES**



**DFS-7400**  
Double Spring Floor Hinge

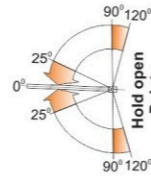
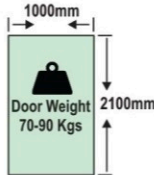

- Specification**
- Ove 5,00,000 cycles tested.
  - General design, suitable for left or right hand to open the door in single and both sides.
  - Universal machine cylinder.
  - Closing force-25nm.
  - Maximum wide door Size-1000x2100mm.
  - Maximum door weight-70-90kgs
  - Speed covering control-two stage adjustable speed.
  - Location-90° hold open

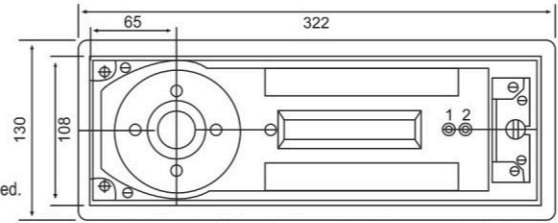

**TESTED TO 500000 CYCLES**



**DFS-9400**  
Double Spring Floor Hinge

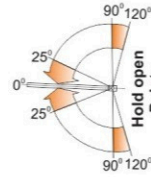
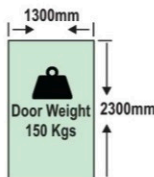

- Specification**
- Ove 5,00,000 cycles tested.
  - General design, suitable for left or right hand to open the door in single and both sides.
  - Universal machine cylinder.
  - Closing force-25nm.
  - Maximum wide door Size-1300x2300mm.
  - Maximum door weight-150kgs
  - Speed covering control-two stage adjustable speed.
  - Location-90° hold open

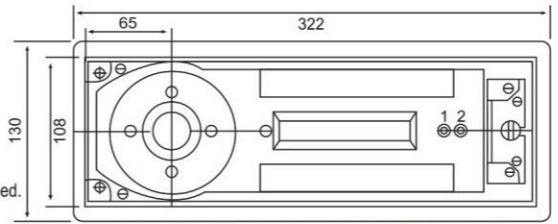

**TESTED TO 500000 CYCLES**



**DFS-6400**  
Single Spring Floor Hinge

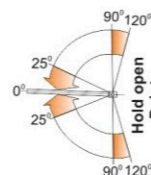
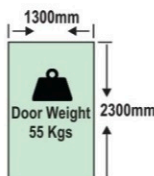

- Specification**
- Ove 5,00,000 cycles tested.
  - General design, suitable for left or right hand to open the door in single and both sides.
  - Universal machine cylinder.
  - Closing force-15nm.
  - Maximum wide door Size-900x2100mm.
  - Maximum door weight-55kgs
  - Speed covering control-two stage adjustable speed.
  - Location-90° hold open



**DFS-ACC-TP/BP**  
Top Pivot/Bottom Pivot  
for Wooden/Aluminium Doors

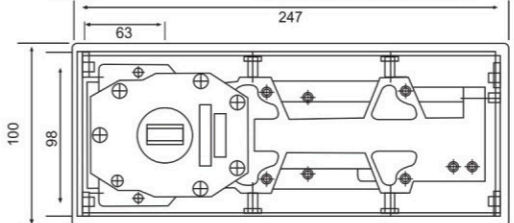

## Combo Patch Set

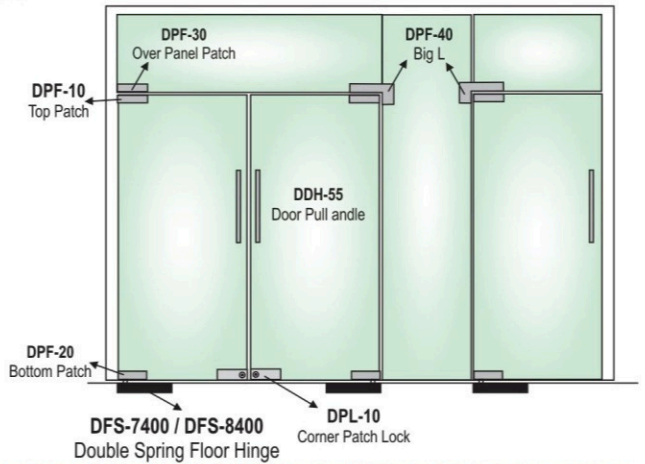
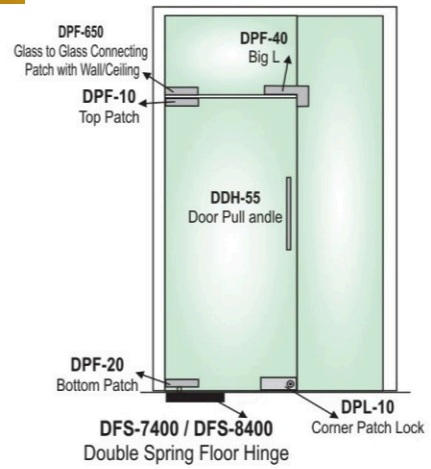
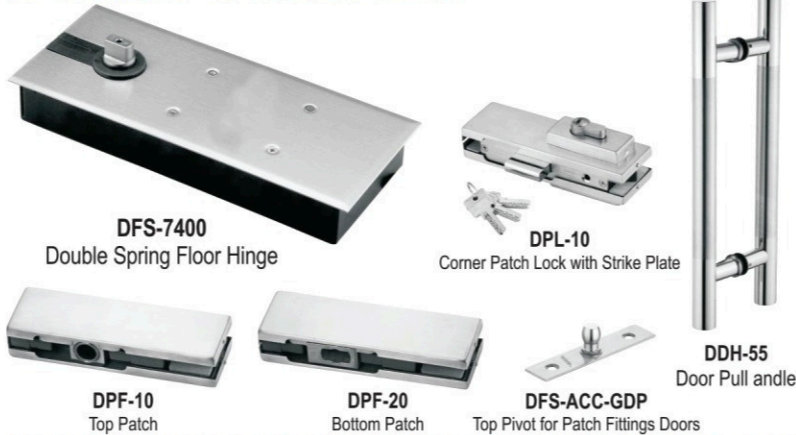

## Hydraulic Patch

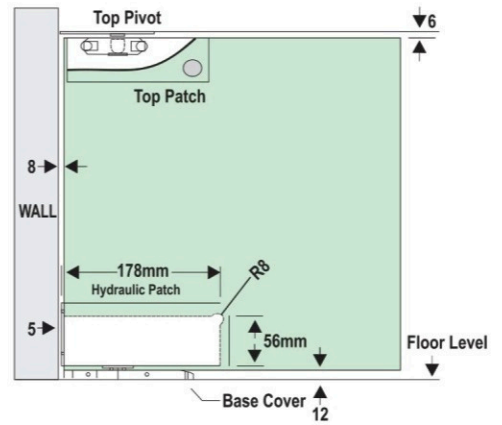
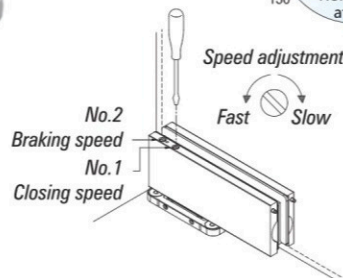
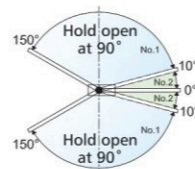
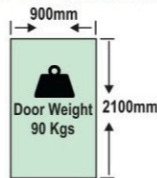

Maximum open degree Left side 150° Right side 150°  
 90° Hold-Open Function  
 Closing Speed 150°- 10°  
 Buffering Speed 10°- 0°  
 Adjustment can be individually  
 Hold open at 90°

## Hydraulic Patch Combo Set

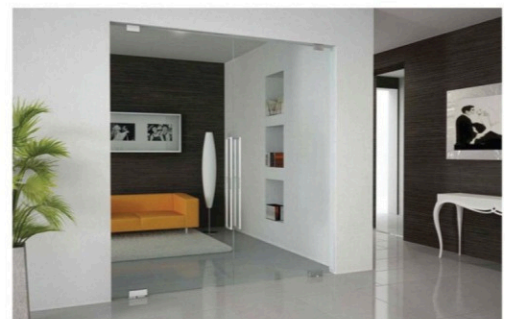

# Patch Fittings



**DPF-10**  
Top Patch

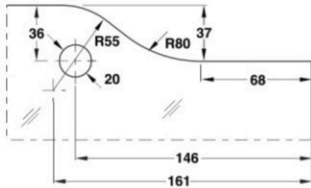

Cut Out for DPF-10



**DPF-20**  
Bottom Patch

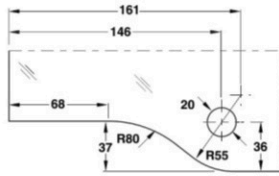

Cut Out for DPF-20



**DPF-30**  
Over Panel Patch

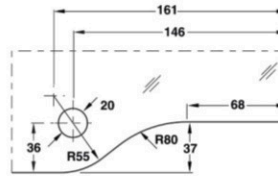

Cut Out for DPF-30



**DPF-40**  
Big L

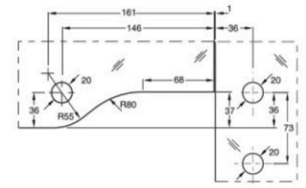

Cut Out for DPF-40



**DPL-10**  
Corner Patch Lock with Strike Plate

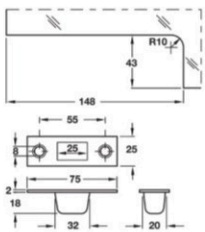

Cut Out for DPL-10



**DPF-41 (L)**  
Big L with Fin (Left)

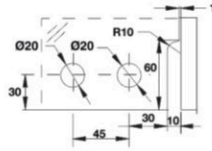

Cut Out for DPF-41 (L) & DPF-41 (R)



**DPF-41 (R)**  
Big L with Fin (Right)

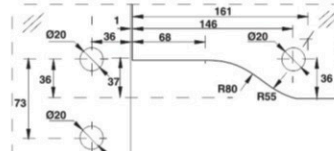

**DPF-51**  
Double Over Panel Patch with Fin

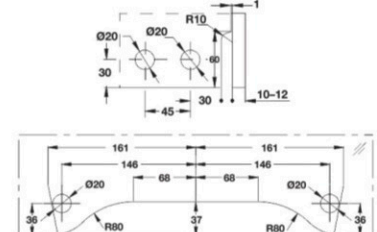

Cut Out for DPF-51



**DPF-610**  
Small L

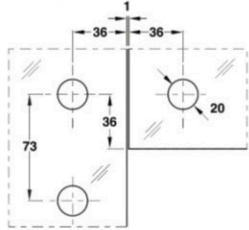

Cut Out for DPF-610



**DPF-620 (F)**  
Quadruple Patch with Fin

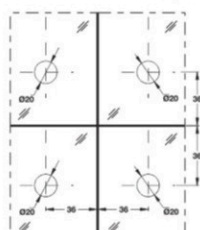

Cut Out for DPF-620 (F)



**DVPF-610 ST**  
Over Panel Side Panel Patch Connector with Stopper

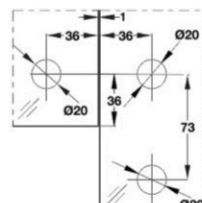

Cut Out for DVPF-610 ST



**DPF-61**  
Double Over Panel Patch

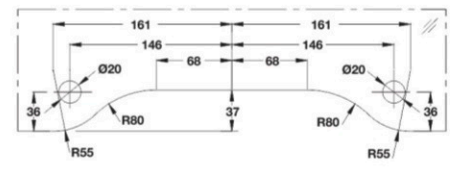

Cut Out for DPF-61



**DPL-2A**  
Centre Patch Lock

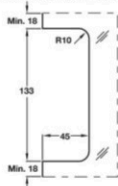

Cut Out for DPL-2A



**DPL-2B**  
Centr Strike Box

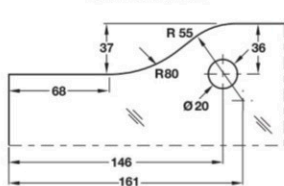

Cut Out for DPL-2A



**DPL-3A**  
Latch Lock

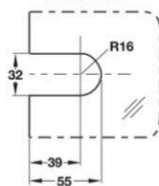

Cut Out for DPL-3A



**DPL-3B**  
Strike Box

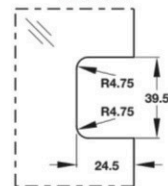

Cut Out for DPL-3B



**DPF-610 L/R**  
Small L with Fin (Left/Right)

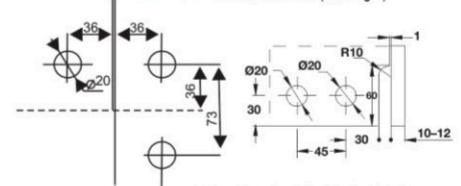

Cut Out for DPF-610 (L/R)

# Patch Fittings



**DPF-620**  
Quadruple Patch

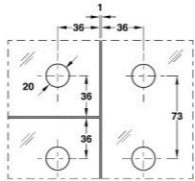

Cut Out for DPF-620



**DPF-630**  
Connector with Fin

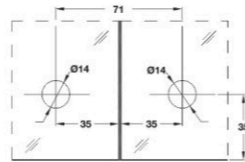

Cut Out for DPF-630



**DPF-640**  
Wall to Glass Connecting Patch

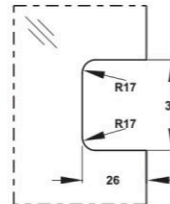

Cut Out for DPF-640



**DPF-650**  
Glass to Glass Connecting Patch with Wall/Ceiling

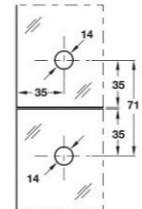

Cut Out for DPF-650



**DFS-MFH**  
Mini Floor Hinge

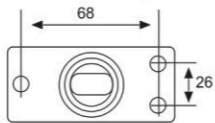

Cut Out for DFS-MFH



**DFS-ACC-GDP**  
Top Pivot for Patch Fittings Doors

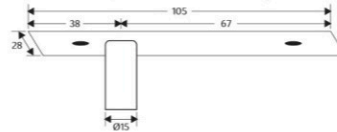

Cut Out for DFS-ACC-GDP



**DGDS**  
Glass Door Stopper

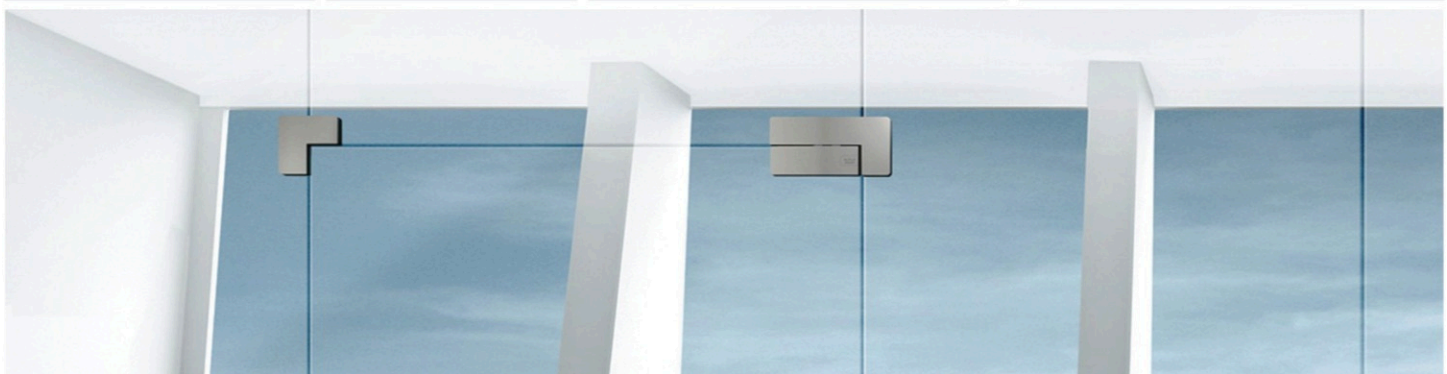
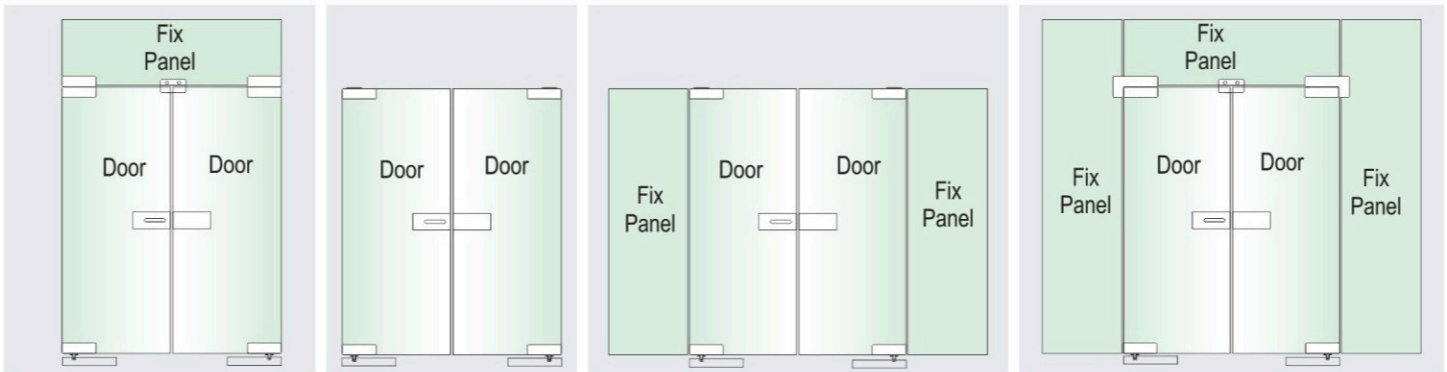
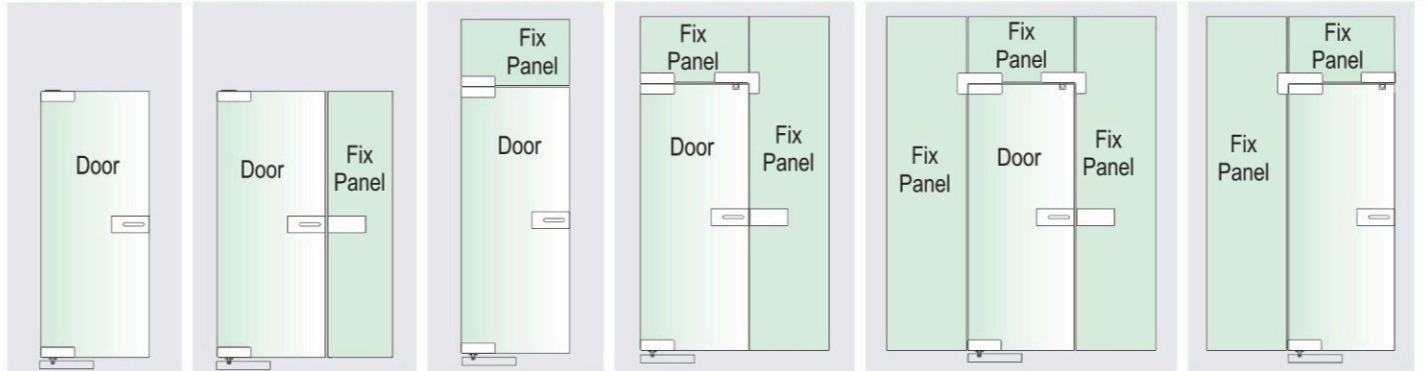



# Glass Connectors



**DGC-1**  
U Connector



**DGC-11**  
U Connector

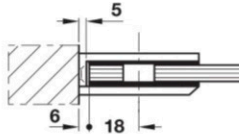

Material - Stainless Steel 304  
Door Thickness - 8mm-12mm  
Finish - Chrome Plated  
With Gasket to Prevent Glass from Damage

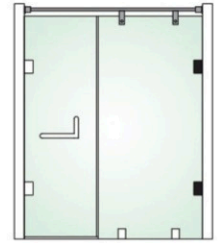
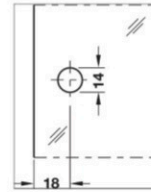

**DGC-2**  
Glass to Glass 135°



**DGC-22**  
Glass to Glass 135°

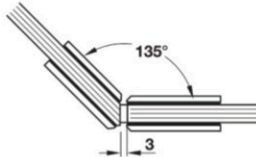

Material - Stainless Steel 304  
Door Thickness - 8mm-12mm  
Finish - Chrome Plated  
With Gasket to Prevent Glass from Damage

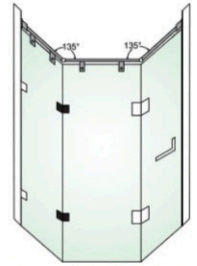
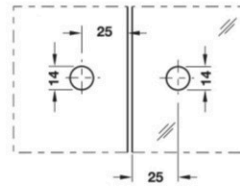

**DGC-3**  
Glass to Glass 90°



**DGC-3**  
Glass to Glass 90°

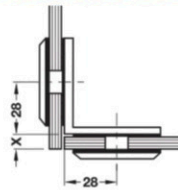

Material - Stainless Steel 304  
Door Thickness - 8mm-12mm  
Finish - Chrome Plated  
With Gasket to Prevent Glass from Damage

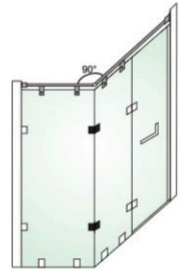
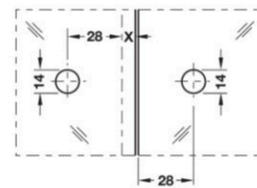

**DGC-4**  
L Connector



**DGC-4**  
L Connector

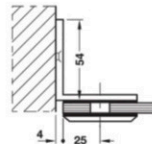

Material - Stainless Steel 304  
Door Thickness - 8mm-12mm  
Finish - Chrome Plated  
With Gasket to Prevent Glass from Damage

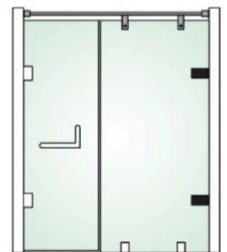
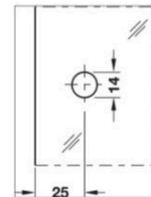

**DGC-5**  
Glass to Glass 180°



**DGC-5**  
Glass to Glass 180°

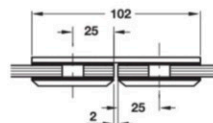

Material - Stainless Steel 304  
Door Thickness - 8mm-12mm  
Finish - Chrome Plated  
With Gasket to Prevent Glass from Damage

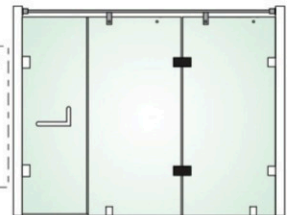
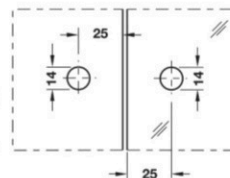

**DGC-6**  
T Connector Glass to Glass 90°

Material - Stainless Steel 304  
Door Thickness - 8mm-12mm  
Finish - Chrome Plated  
With Gasket to Prevent Glass from Damage

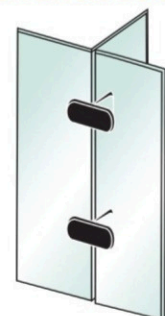
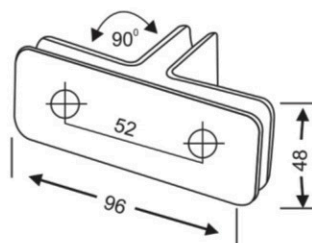

# Shower Hinges

## Brass Hinges

## SS Super Fine Hinges



**DSH-1**  
Wall to Glass 90° Hinge



**DSH-11**  
Wall to Glass 90° Hinge

Door Thickness : 8mm-12mm  
Weight Cap. : 45kg  
Finish : Matt & Chrome Plated  
With Gasket to Prevent Glass from Damage

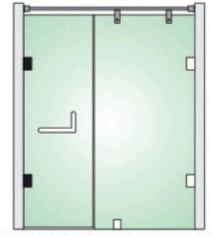
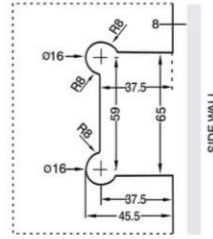

**DSH-2**  
Glass to Glass 180° Hinge



**DSH-22**  
Glass to Glass 180° Hinge

Door Thickness : 8mm-12mm  
Weight Cap. : 45kg  
Finish : Matt & Chrome Plated  
With Gasket to Prevent Glass from Damage

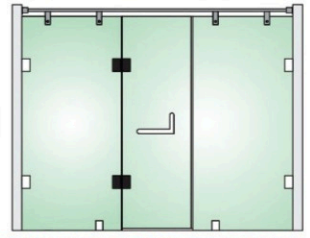
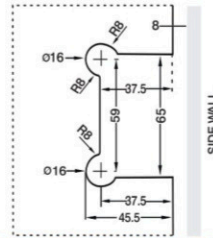

**DSH-3**  
Glass to Glass 135° Hinge



**DSH-33**  
Glass to Glass 135° Hinge

Door Thickness : 8mm-12mm  
Weight Cap. : 45kg  
Finish : Matt & Chrome Plated  
With Gasket to Prevent Glass from Damage

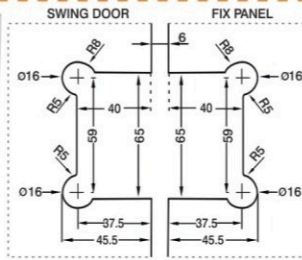

**DSH-4**  
Glass to Glass 90° Hinge



**DSH-44**  
Glass to Glass 90° Hinge

Door Thickness : 8mm-12mm  
Weight Cap. : 45kg  
Finish : Matt & Chrome Plated  
With Gasket to Prevent Glass from Damage

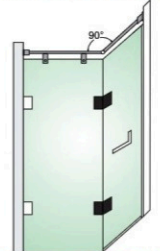
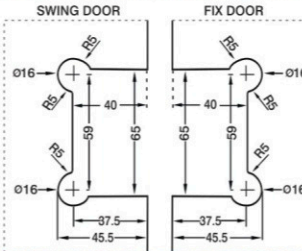

**DSH-5**  
Wall to Glass 90° Fix Bracket



**DSH-55**  
Wall to Glass 90° Fix Bracket

Door Thickness : 8mm-12mm  
Weight Cap. : 45kg  
Finish : Matt & Chrome Plated  
With Gasket to Prevent Glass from Damage

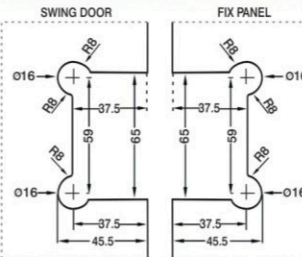

**DSH-6**  
Wall to Glass 90° Off Set Hinge



**DSH-66**  
Wall to Glass 90° Off Set Hinge

Door Thickness : 8mm-12mm  
Weight Cap. : 45kg  
Finish : Matt & Chrome Plated  
With Gasket to Prevent Glass from Damage

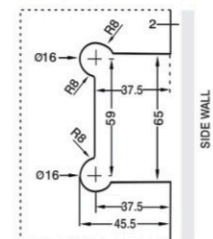

**DSH-77**  
Three Glass T Connector

Door Thickness : 8mm-12mm  
Weight Cap. : 45kg  
Finish : Matt & Chrome Plated  
With Gasket to Prevent Glass from Damage

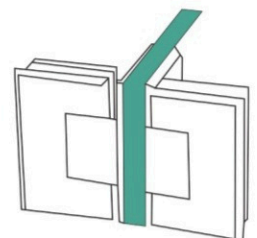
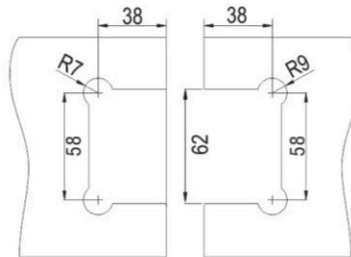

## Plastic Profiles (2.2 mtr.)

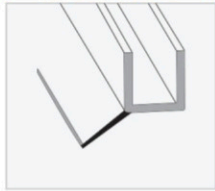

**DPS-1 (Wall Seal)**  
8mm (2.2mtr.)  
10mm (2.2mtr.)  
12mm (2.2mtr.)



**DPS-2 (Center Seal)**  
8mm (2.2mtr.)  
10mm (2.2mtr.)  
12mm (2.2mtr.)

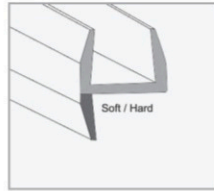

**DPS-3 (Central Seal)**  
8mm (2.2mtr.)  
10mm (2.2mtr. & 2.5mtr.)  
12mm (2.2mtr. & 2.5mtr.)



**DPS-4 (D Seal)**  
8mm (2.2mtr.)  
10mm (2.2mtr. & 2.5mtr.)  
12mm (2.2mtr. & 2.5mtr.)

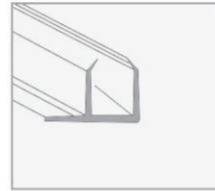

**DPS-6 (Sliding Door Seal)**  
8mm (2.2mtr.)  
10mm (2.2mtr. & 2.5mtr.)  
12mm (2.2mtr. & 2.5mtr.)

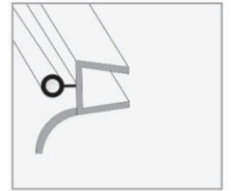

**DPS-7 (Water Dispersal Seal)**  
8mm (2.2mtr.)  
10mm (2.2mtr.)  
12mm (2.2mtr.)

## Magnetic Profiles (2.2 mtr.)

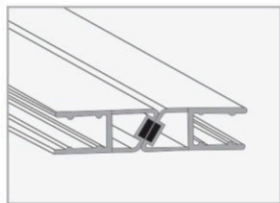

**DPS-M1 (180°)**  
8mm (2.2mtr.)  
10mm (2.2mtr. & 2.5mtr.)  
12mm (2.2mtr. & 2.5mtr.)

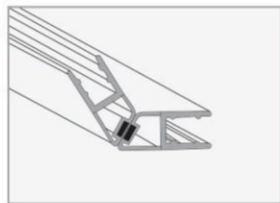

**DPS-M2 (135°)**  
8mm (2.2mtr.)  
10mm (2.2mtr. & 2.5mtr.)  
12mm (2.2mtr. & 2.5mtr.)

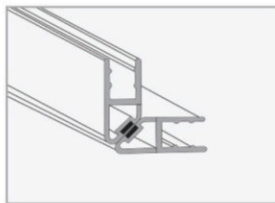

**DPS-M3 (90°)**  
8mm (2.2mtr.)  
10mm (2.2mtr. & 2.5mtr.)  
12mm (2.2mtr. & 2.5mtr.)



## Shower Knight Head Accessories Round Series Dia19mm



**DKH-1 (Brass)**  
Wall to Rod (Dia 19mm)

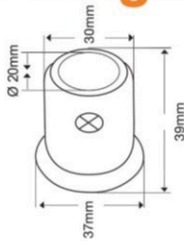

**DKH-2 (Brass)**  
Rod to Glass (Dia 19mm)

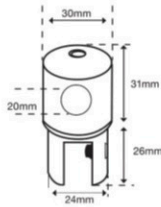

**DKH-3 (Brass)**  
Rod to Rod (Dia 19mm)

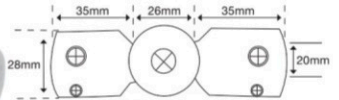

**DKH-4 (Brass)**  
Rod to Glass (One Side Blind)



**DKH-5 (Brass)**  
Rod to Rod T Connector (Dia 19mm)

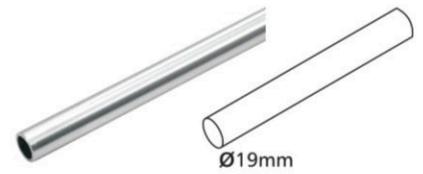
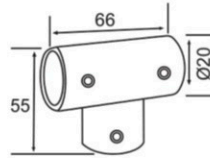

**DKH-6**  
Reinforcing Rod (Dia 19mm)

## Square Series Dia 25mm



**DKH-11 (SS)**  
Wall to Rod (Dia 25mm)



**DKH-22 (SS)**  
Rod to Glass (Dia 25mm)



**DKH-33 (SS)**  
Rod to Rod (Dia 25mm)



**DKH-44 (SS)**  
Rod to Glass (One Side Blind)



**DKH-55 (SS)**  
Rod to Rod T Connector (Dia 25mm)



**DKH-66**  
Reinforcing Rod (Dia 25mm)

## Rectangle Series Dia 10x30mm



**DKH-111 (SS)**  
Wall to Track Connector (10x30mm)



**DKH-222 (SS)**  
Track to Glass Connector (10x30mm)



**DKH-333 (SS)**  
Track to Track Connector (10x30mm)



**DKH-ACC-10/30**  
Connecting Track (10x30mm)

# Shower Sliding System (Set)-A1

DSL-11-A1 - 2 Big Rollers, 2 Small Rollers, DSL-11-A2 - 2 Track to Glass Holder,  
 DSL-11-A3 - 2 Stopper, DSL-11-A4 - 1 Floor Guide, DSL-11-A5 - 2 Wall to Track Connector

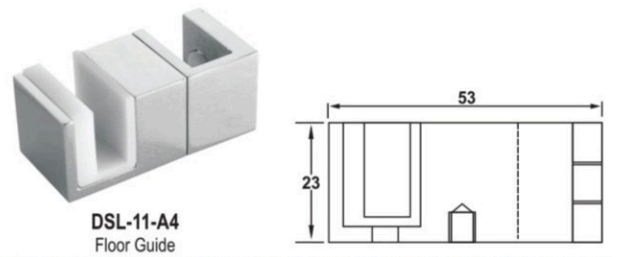
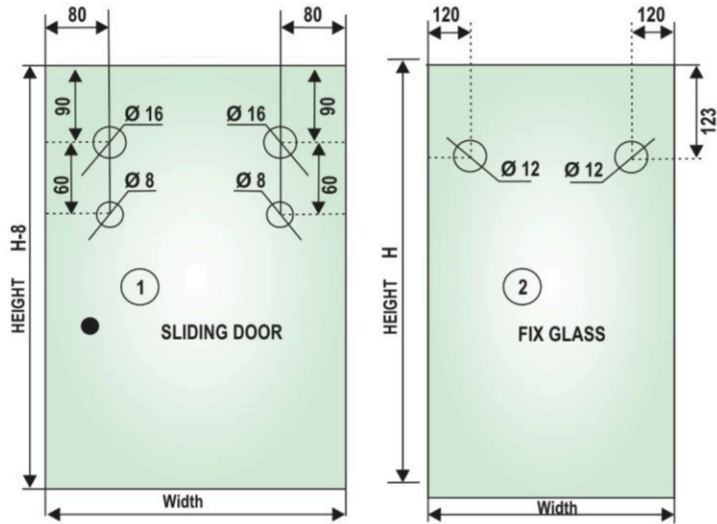

# Sliding Door System

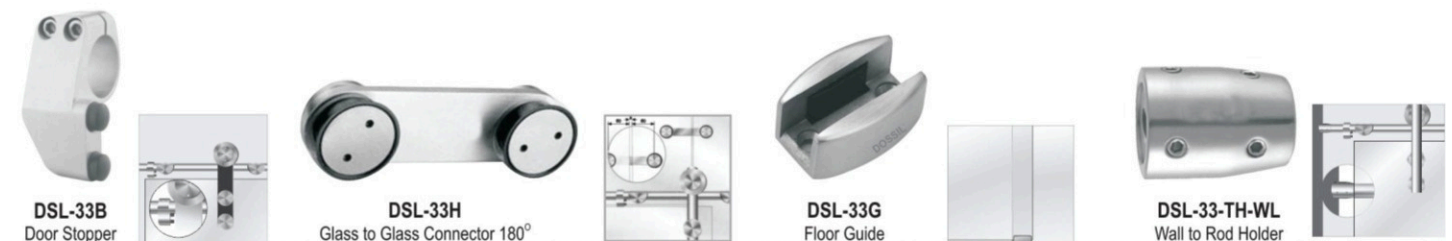
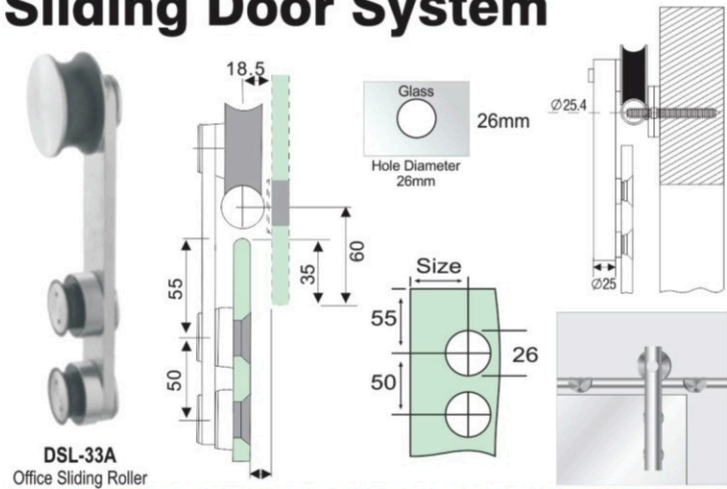

# Office Sliding System Set



**DSL-44-A1 (Set)**  
Roller (S.S.)

DSL-44-A1 - 2 Rollers  
DSL-44-A3 - 2 Stopper  
DSL-44G - 1 Floor Guide

**Specification**

- Four fiber reinforced plastic rollers of 30 mm diameter
- Stainless Steel Grade 304 glass holding point
- Height adjustable glass holding points (10 mm)
- Secure grip for the door
- Self aligning suspension of door
- Roller configuration for even distribution of load
- Independently connected rollers to prevent damage to track and rollers
- Suitable for 10 mm or 12 mm glass
- Suitable for door weight 40 kg.

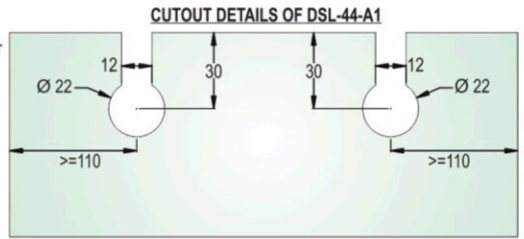

**DSL-44-A2 (Set)**  
Roller (Brass)

DSL-44-A2 - 2 Rollers  
DSL-44-A3 - 2 Stopper  
DSL-44G - 1 Floor Guide

**Specification**

- Heavy duty sliding door roller
- Suitable for up to a door weight of 80 Kg
- Larger surface area for secure grip of the door
- Adjustable threaded rod for installation perfection
- Solid brass for glass holding

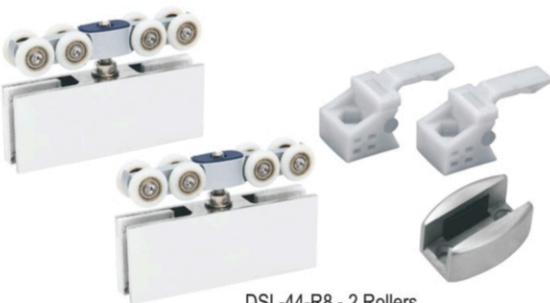
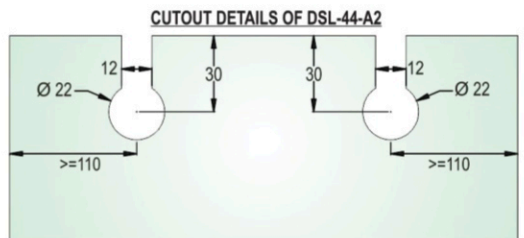

**DSL-44-R8 (Set)**  
8 Wheel Rectangular Roller (SS)

DSL-44-R8 - 2 Rollers  
DSL-44-A3 - 2 Stopper  
DSL-44G - 1 Floor Guide

**Specification**

- Material : Stainless steel 304 grade
- Finish : Satin stainless steel (SSS)

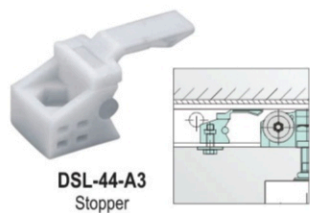
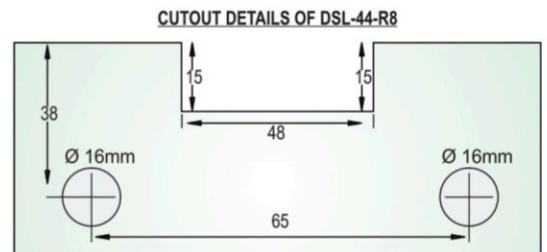

**DSL-44-A3**  
Stopper



**DSL-44-A5**  
Wall to Track Clamp



**DSL-44-A6**  
Glass to Track Clamp



**DSL-44G**  
Floor Guide

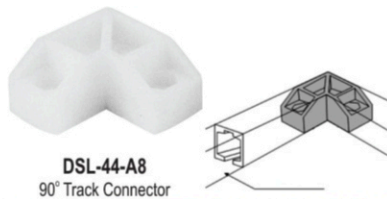

**DSL-44-A8**  
90° Track Connector



**DSL-44-A9**  
Wall to Track Connector

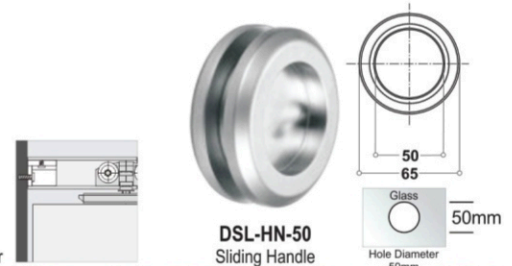

**DSL-HN-50**  
Sliding Handle



**DSL-HN-60**  
Sliding Handle

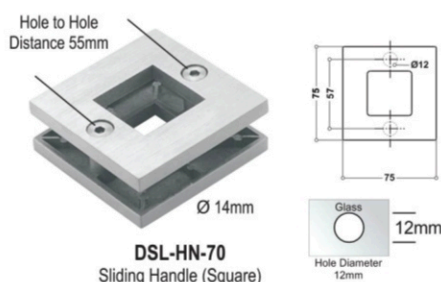

**DSL-HN-70**  
Sliding Handle (Square)



**DSL-HN-80**  
Sliding Handle (Rectangle)

## Office Sliding System Acc. Track

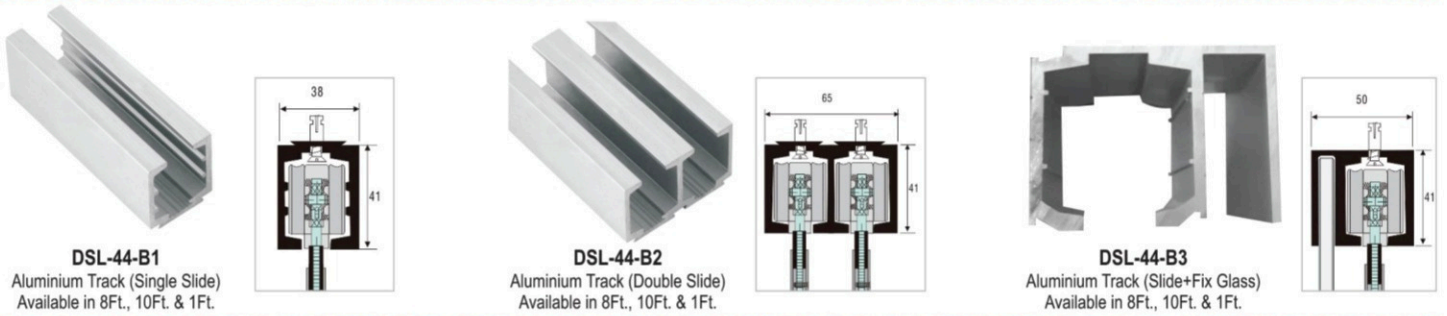

## Jaguar Sliding System Set



## Automatic Sliding Sensor Door

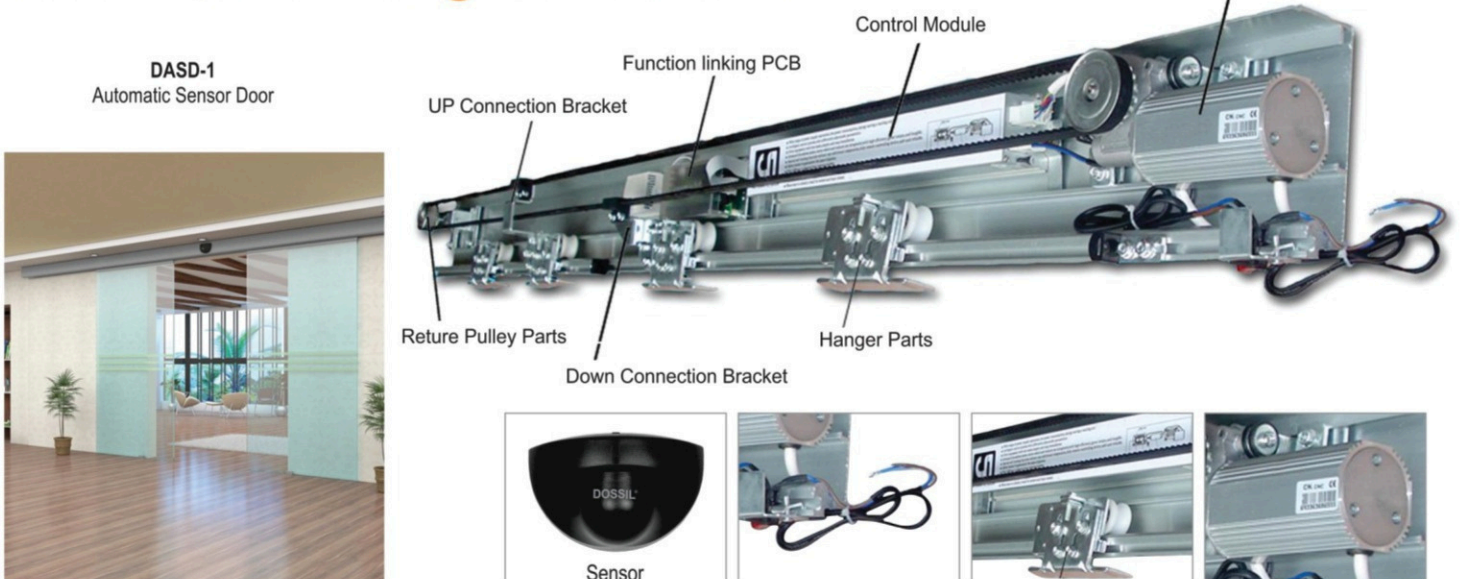



**GLASSEXCEL**  
architecture hardware



# Sliding Folding System

- Maximum weight per door : 70kg
- Maximum height per door : 2500mm
- Maximum width per door : 900mm
- Suitable for 8 to 10mm glass thickness



**DSF-6**  
Glass to Glass Center Hinge

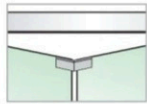

**DSF-9**  
Wall to Glass Hinge

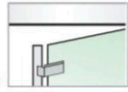

**DSF-10**  
Center Hinge with Roller



**DSF-11**  
End Hinge with Roller



**DSF-12**  
Glass to Glass Center Hinge with Guide



**DSF-13 L/R**  
Glass to Glass Center Hinge with Lock

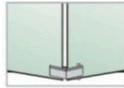

**DSF-14**  
End Hinge with Guide



**DSF-16**  
Fixed Hinge

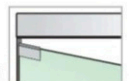

**DSF-17**  
Floor Fixed Hinge



**DSF-18 L/R**  
End Panel Fitting with Bottom Pivot

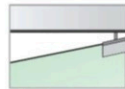

**DSF-19**  
Floor Track Bottom (S.S.)



**DSF-20**  
Aluminium Track (Top)

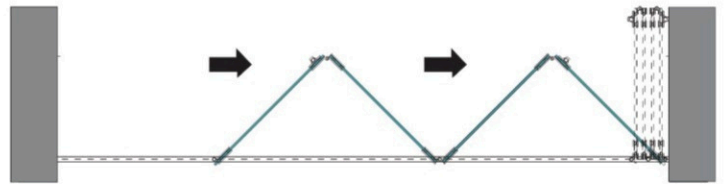

# Center Sliding Folding System



**DCSF-1**  
Folding Door Roller

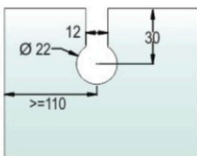

**DCSF-2**  
Glass to Wall Hinge

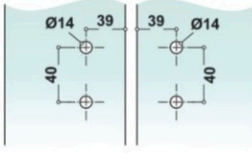

**DCSF-3**  
Glass to Glass Hinge

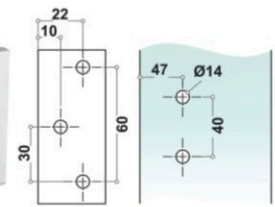

**DCSF-LK**  
Sliding Glass Door Lock



**DCSF-5**  
Knob Sleeve

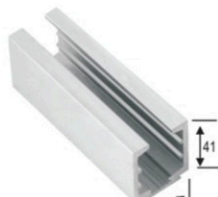

**DCSF-6**  
Aluminium Track

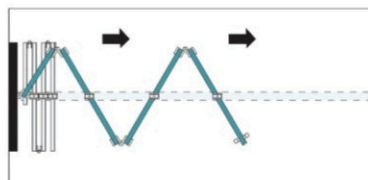

## Locks Without Cutout



**DGL-11**  
Single Door Lock (Only Key)



**DGL-22**  
Double Door Lock (Only Key)



**DGL-33**  
Single Door Lock (Key & Knob)



**DGL-44**  
Double Door Lock (Key & Knob)

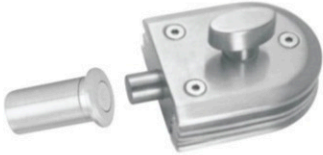

**DGL-55**  
Single Door Lock (Only Knob)



**DGL-66**  
Double Door Lock (Only Knob)

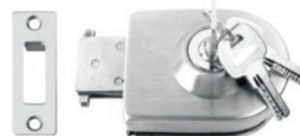

**DGL-77**  
Single Door Lock (Only Key)



**DGL-88**  
Double Door Lock (Only Key)



**DGL-99 (Pin Type)**  
Mini Single Door Lock (Key & Knob)



**DGL-100 (Pin Type)**  
Mini Double Door Lock (Key & Knob)



**DGL-111**  
Single Door Lock (Only Knob)



**DGL-122**  
Double Door Lock (Only Knob)

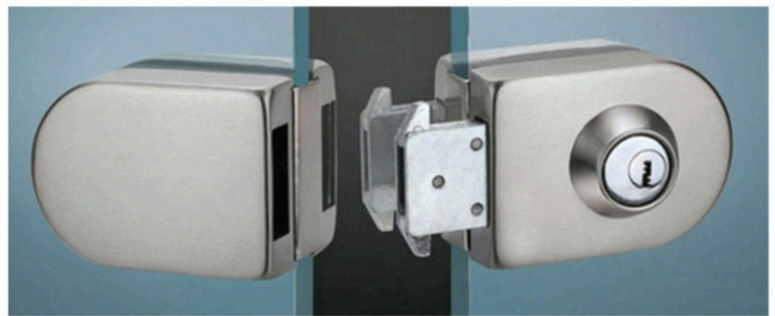

## Canopy Fittings



**DCF-1**  
Wall to Glass Connector

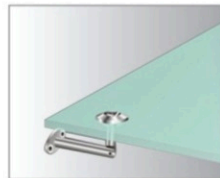
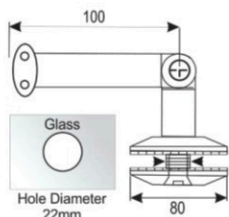

**DCF-2**  
Rod to Glass Connector

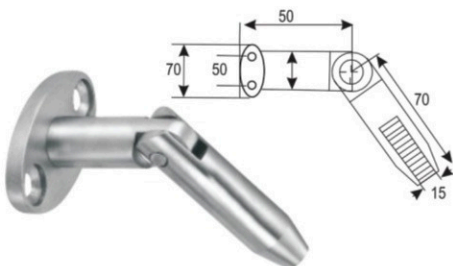

**DCF-3**  
Wall to Rod Connector

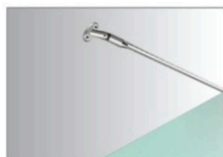
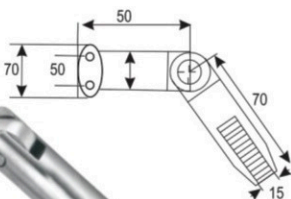

**DCF-ROD (16mm)**  
Canopy Rod with Thread



# Profile Telescopic Sliding System (Soft Close)

## Features

Telescopic Sliding System for Three Doors, Two Doors and Single Door, Suitable for Sliding Doors for Homes, Hotels, Office Buildings etc.  
 Space Saving, Good Decorative, Sliding Track: Aluminium Anodized, Hanging Roller: Zinc Alloy, SN.

## Profile Telescopic Sliding System (Soft Close) 3+1 Telescopic System

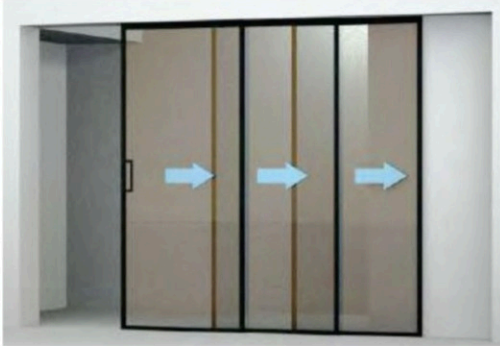

**DPSS-100 (Soft Close)**  
Telescopic Sliding System (3 Door)

- 3 Door Telescopic Accessories Set.
- Sliding Top Track.
- Track Decorative Cover .
- Top & Bottom Profile.
- Side Profile.
- Handles.
- Divider Profile as Per Requirement.

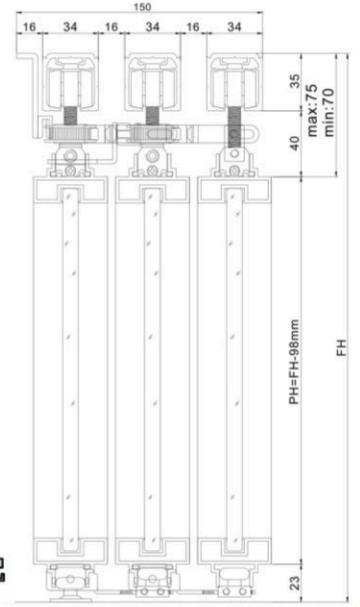
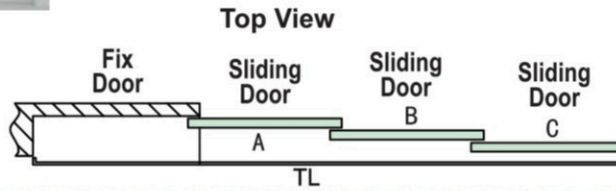
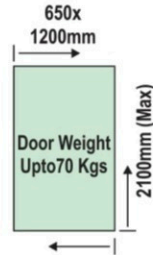

## Profile Telescopic Sliding System (Soft Close) 2+1 Telescopic System



**DPSS-101 (Soft Close)**  
Telescopic Sliding System (2 Door)

- 2 Door Telescopic Accessories Set.
- Sliding Top Track.
- Track Decorative Cover .
- Top & Bottom Profile.
- Side Profile.
- Handles.
- Divider Profile as Per Requirement.

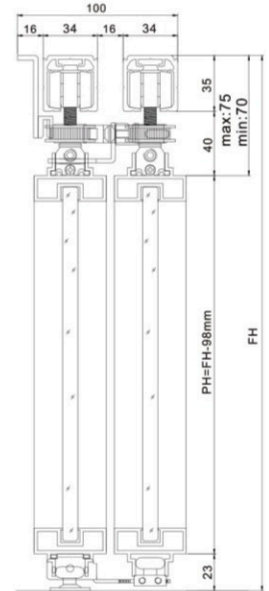
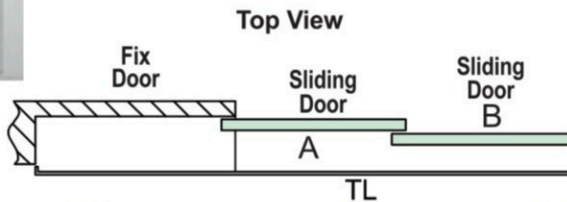
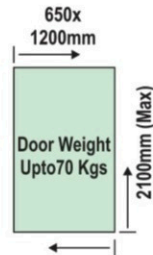

## Profile Telescopic Sliding System (Soft Close) Single Door Telescopic System



**DPSS-102 (Soft Close)**  
Telescopic Sliding System (Single Door)

- Single Door Telescopic Accessories Set.
- Sliding Top Track.
- Track Decorative Cover .
- Top & Bottom Profile.
- Side Profile.
- Handles.
- Divider Profile as Per Requirement.

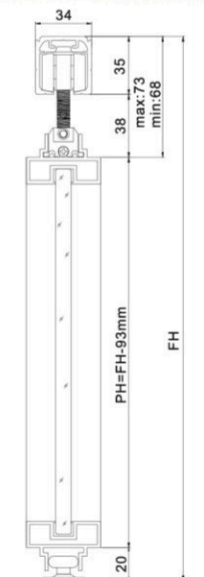
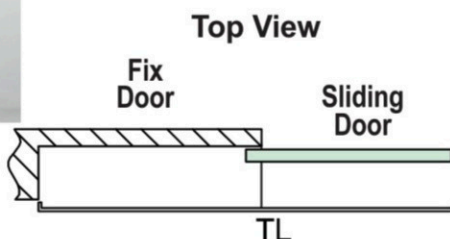
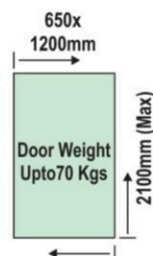

# Profile Synchronized Sliding System

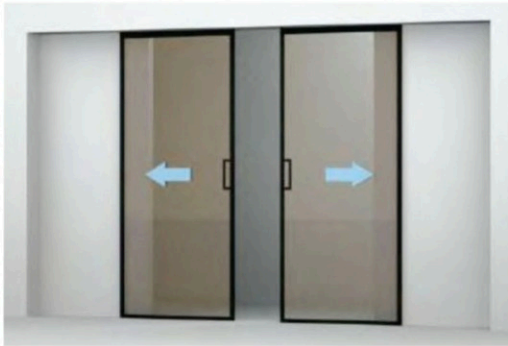

**DPSS-103 (Soft Close)**  
Profile Synchronized Sliding System

Synchronized Accessories Set.  
 Sliding Top Track.  
 Track Decorative Cover .  
 Top & Bottom Profile.  
 Side Profile.  
 Handles.  
 Divider Profile as Per Requirement.

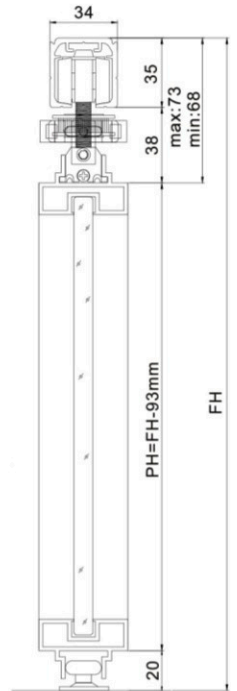
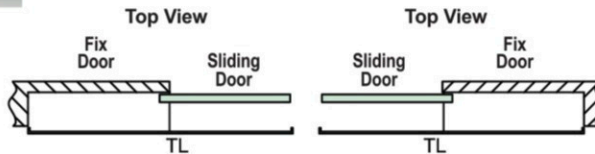
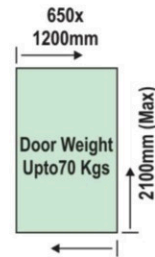

## PROFILE TELESCOPIC SLIDING SYSTEM (ACCESSORIES FOR FITTING)

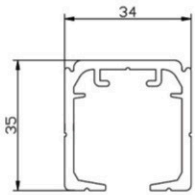

**DPTS-104**  
Top Sliding Track



**DPTS-105**  
Sliding Channel  
Cover Plate

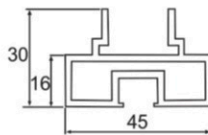

**DPTS-106**  
Top and Bottom Channel

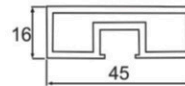

**DPTS-107**  
Vertical Profile



**DPTS-108**  
Adjustable Fix Connector  
for Runner

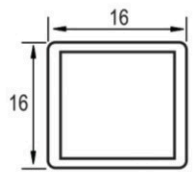

**DGP -104**  
Sticking Profile

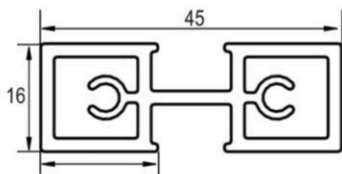

**DGP -105**  
Divider Profile



**DGP -111**  
Profile Corner Jointer

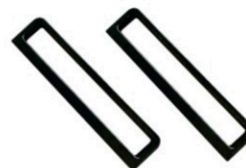

**DPTS-109**  
Profile Sliding Handle



**DPTS-110**  
Profile Sliding Handle  
with Lock

## Accessories for Fitting of Sliding Doors

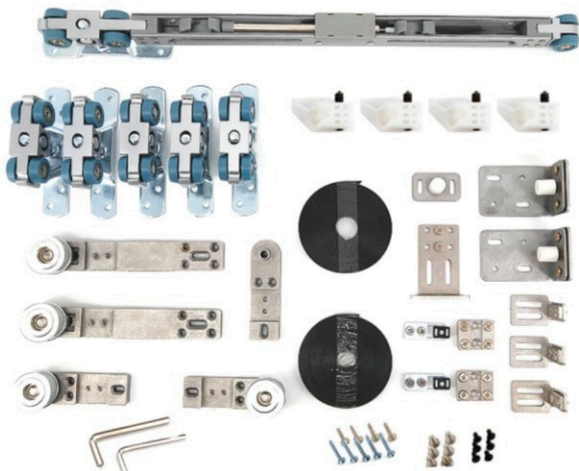



**AMH GLASSEXCEL**  
architecture hardware



## Spider Without Fin

(Available in 200mm Distance)



**DSP-B1**  
1 Way Spider without Fin

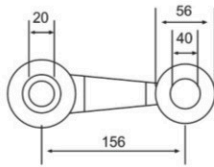

**DSP-B2 (90°)**  
2 Way Spider without Fin

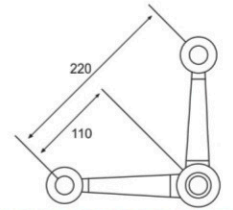

**DSP-B2 (180°)**  
2 Way Spider without Fin

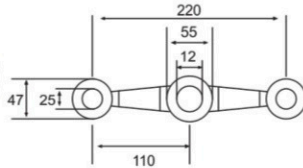

**DSP-B3**  
3 Way Spider without Fin

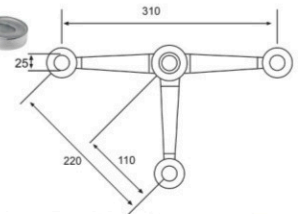

**DSP-B4**  
4 Way Spider without Fin

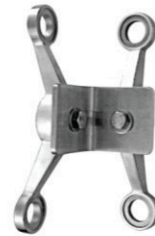
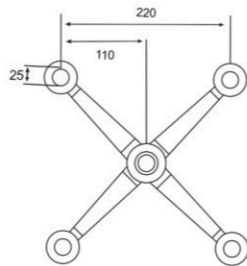

**DSP-B4 (90°)**  
Four Way Spider without Fin (90°)

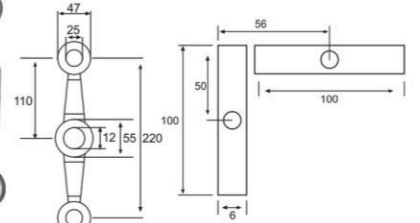

## Spider With Fin



**DSP-A4**  
4 Way Spider with Fin

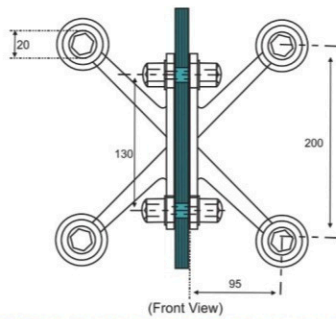

**DSP-A44**  
2 Way Spider 90° for Wall/Ceiling

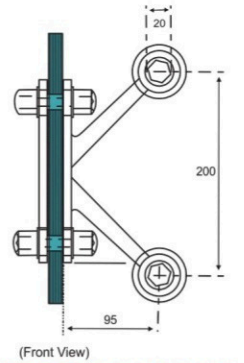

**DSP-A2**  
2 Way Spider 180° with Fin

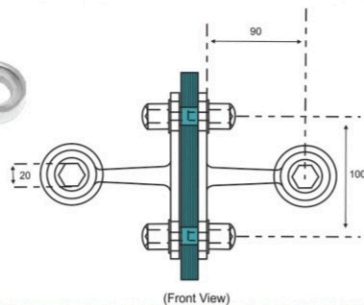

**DSP-A22**  
1 Way Spider for Wall/Ceiling

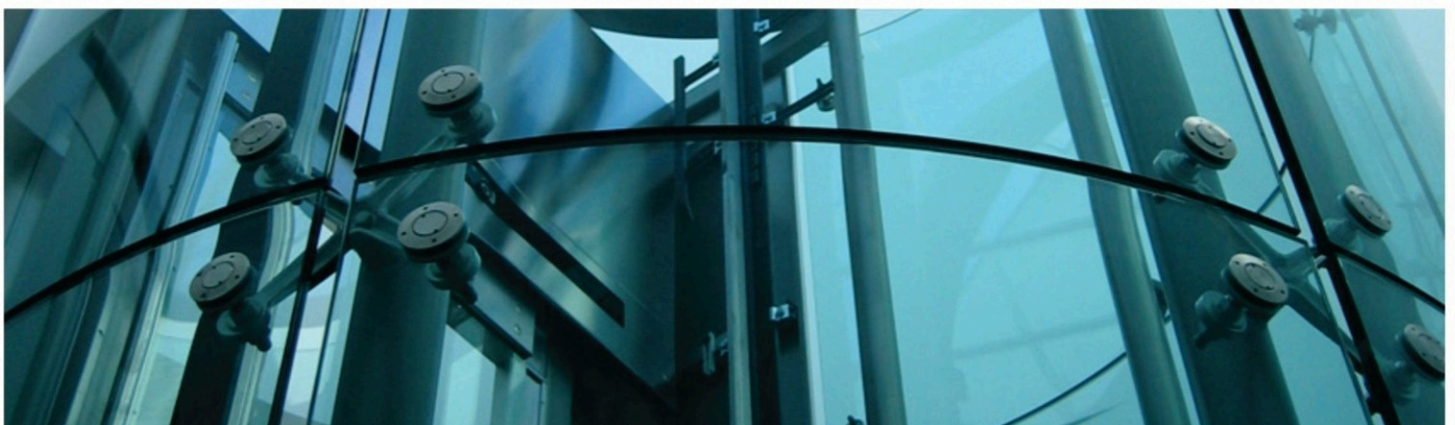
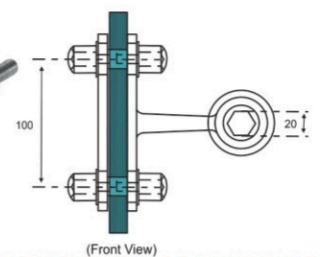



German Technology™  
architecture hardware

## Fin Plates



**DFP-200**  
Fin Plate 200mm

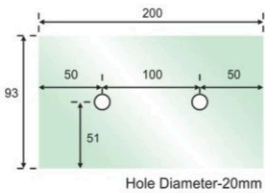

**DFP-300**  
Fin Plate 300mm

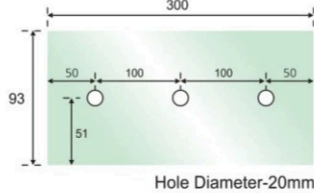

**DFP-350**  
Fin Plate 350mm

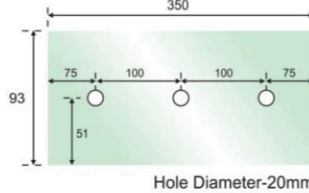

**DFP-400**  
Fin Plate 400mm

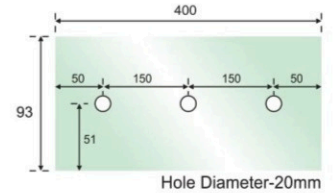

## Splice Plates



**DSP-200**  
Splice Plate 200mm

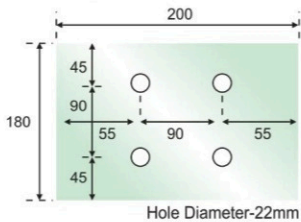

**DSP-250**  
Splice Plate 250mm

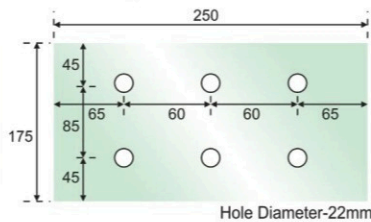

**DSP-300**  
Splice Plate 300mm

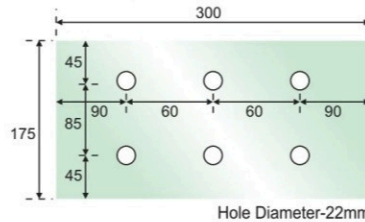

**DSP-350**  
Splice Plate 300mm

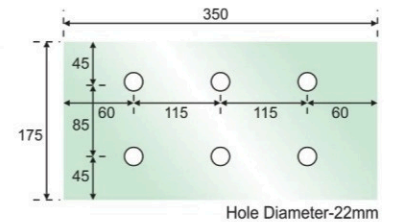

## Routels



**DSP-AFB-36FL**  
Articulated Route

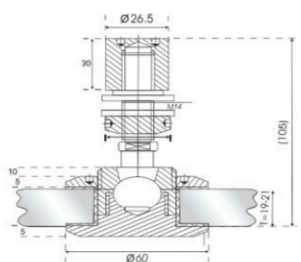

**DSP-FB-36CS**  
Articulated Routel  
with Counter Sunk Hole

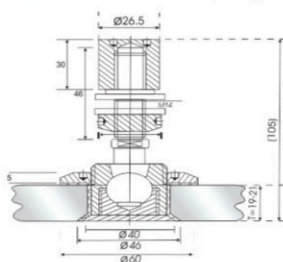

**DSP-FB-FL**  
Fix Routel (Flat Head)

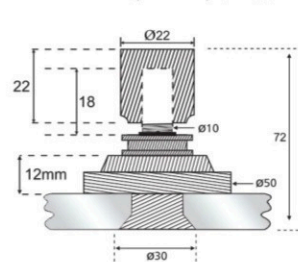

**DSA-01**  
Iron Assembly

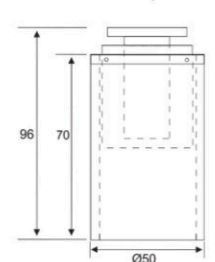

# Door Handles

(All Sizes are in mm)

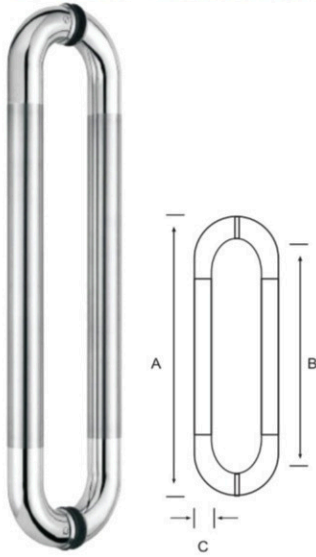

Overall Length (A)	Centre to Centre Hole (B)	Diameter (C)
327	302	25
482	450	32



Overall Length (A)	Centre to Centre Hole (B)	Diameter (C)
325	240	25
457	302	32
600	450	32
900	600	32
900	700	32
1200	900	32

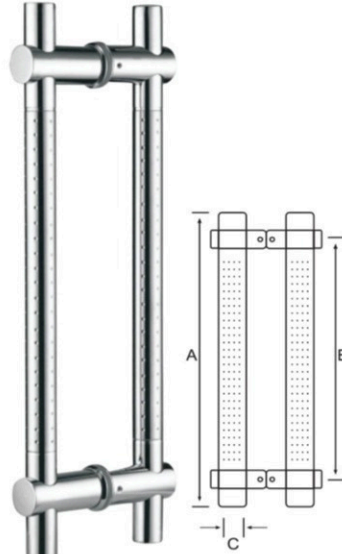

Overall Length (A)	Centre to Centre Hole (B)	Diameter (C)
22	200	25
450	302	32
600	450	32

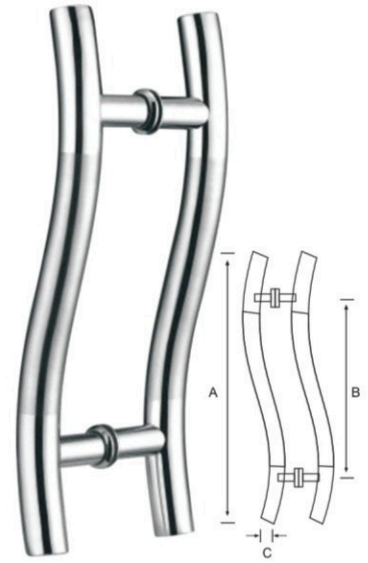

Overall Length (A)	Centre to Centre Hole (B)	Diameter (C)
457	302	32

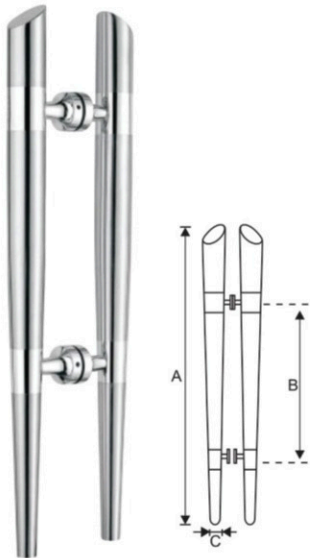

Overall Length (A)	Centre to Centre Hole (B)	Diameter (C)
450	302	38
600	450	38

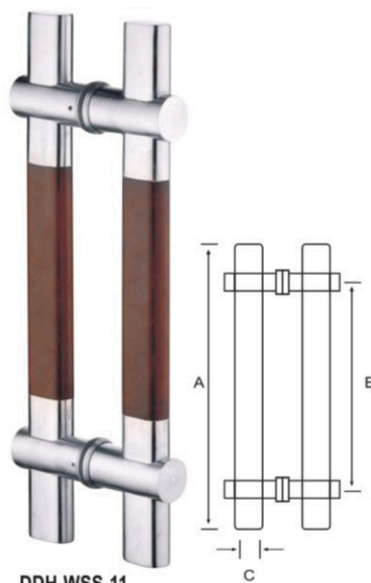

Overall Length (A)	Centre to Centre Hole (B)	Diameter (C)
450	302	25/45
550	454	25/45

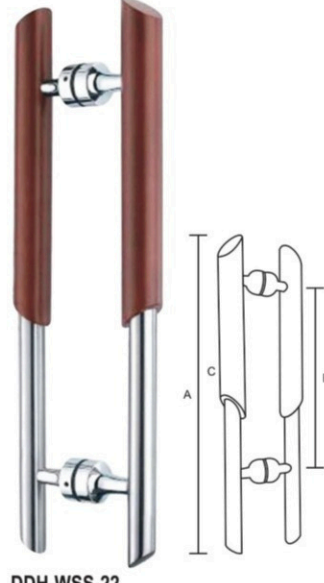

Overall Length (A)	Centre to Centre Hole (B)	Diameter (C)
450	302	38/25

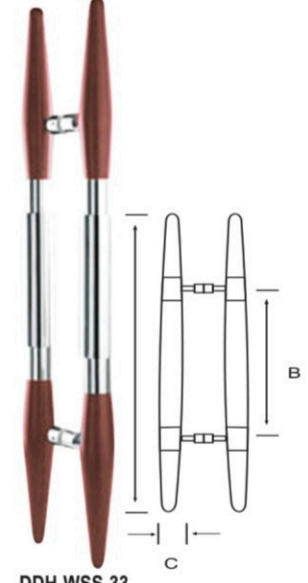

Overall Length (A)	Centre to Centre Hole (B)	Diameter (C)
500	302	38



## Door Handles

(All Sizes are in mm)

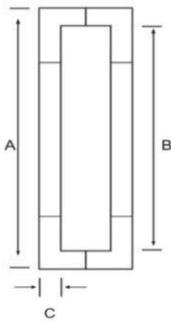
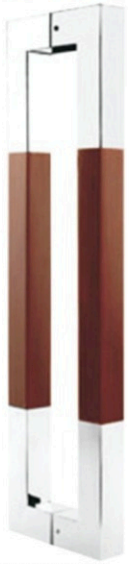

**DDH-WSS-44**

Overall Length (A)	Centre to Centre Hole (B)	Diameter (C)
327	302	25/25
480	450	30/30

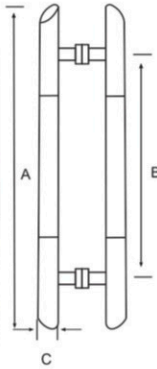

**DDH-55 (Crystal)**

Overall Length (A)	Centre to Centre Hole (B)	Diameter (C)
450	302	38
600	450	38

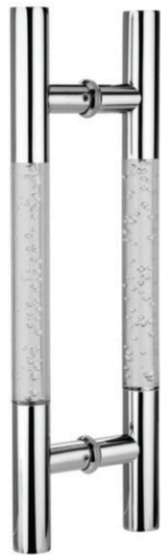

**DDH-66 (Crystal)**

Overall Length (A)	Centre to Centre Hole (B)	Diameter (C)
450	302	38
600	450	38

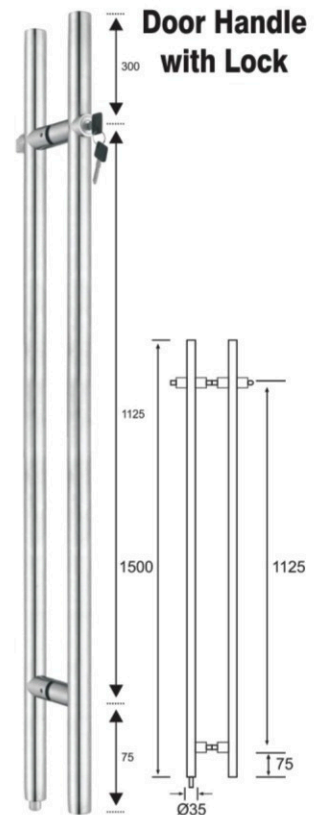

**DDHL-22**

**SIZE**

35x1500

## Shower Handle

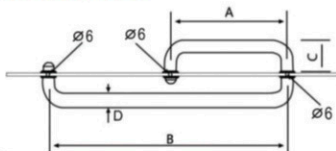
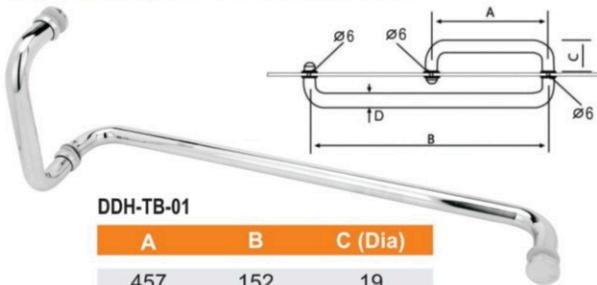

**DDH-TB-01**

A	B	C (Dia)
457	152	19
457	152	25

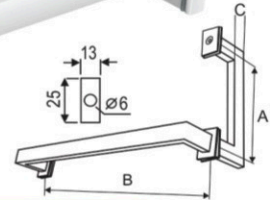
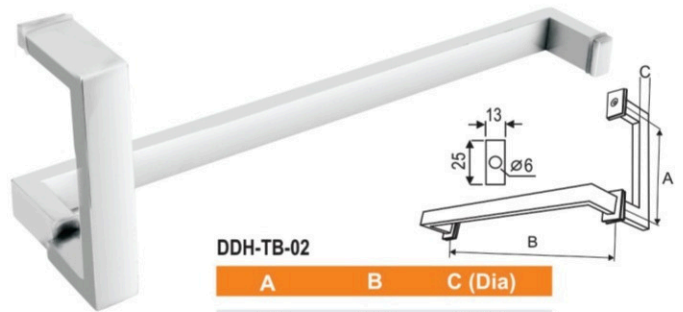

**DDH-TB-02**

A	B	C (Dia)
457	152	15/30

## Door Knobs



**DDK-1**  
Door Knob

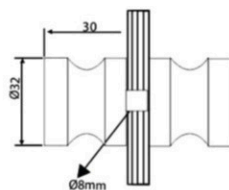

**DDK-2**  
Door Knob

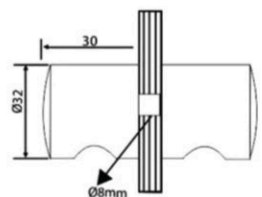

**DDK-3**  
Door Knob

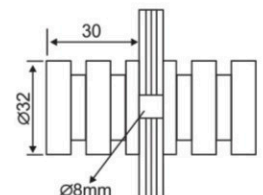

## Glass Railing Accessories



**DRA-1**  
Floor to Glass Holder



**DRA-2**  
Floor to Glass Holder



**DRA-3**  
Floor to Glass Holder



**DRA-4**  
Floor to Glass Holder



**DRA-5 (Mini)**  
Floor to Glass Holder



**DRA-3**  
Wall to Handrail Connector



**DRA-4**  
Glass to Handrail Connector



**DRA-5**  
Glass Connector for  
Baluster with Flat Back



**DRA-6**  
Glass Connector for  
Baluster with Round Back



**DRA-7**  
Wall to Glass Holder

## Aluminium glazing profile and 'U' Channel



**DGPL-1**  
Interlocking Aluminium Glazing Profile

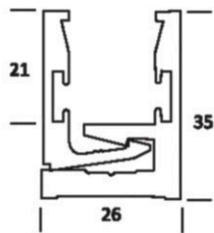

**Specification**  
Material : Aluminium  
For 10 to 12 mm Glass  
Size : 3, 4 & 5 mtr.

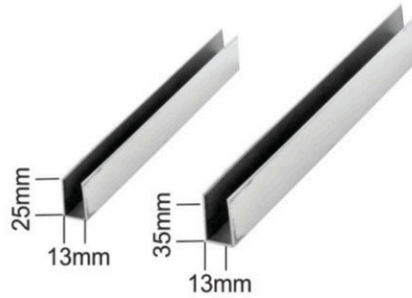

**DGPL-2**  
'U' Channel (For Fixed Glass)  
Finish: CP/ SS  
Available in 3.4 Mtr., Thickness: 1.5mm



## Fixed Profile

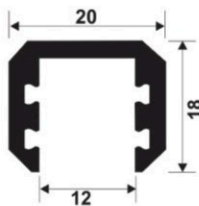

**DGP-113**  
Glass Edge Profile (Black Matt)

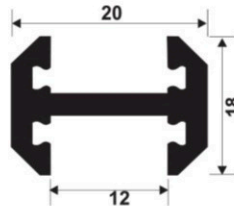

**DGP-114**  
Glass Edge Profile for Partition (Black Matt)



## Mini Hinges (For 5mm-10mm Glass)



**DGH-1**  
Wall to Glass Hinge



**DGH-2**  
Glass to Glass Hinge



**DGH-3**  
Wall to Glass Hinge



**DGH-4**  
Glass to Glass Hinge



**DGH-5**  
Wall to Glass Hinge  
(4-6mm) (8-10mm)

## Bracket Shelf Holders



**DBSH-1**  
Double Shelf Holder  
(10-12mm)



**DBSH-2**  
Single Shelf Holder  
(10-12mm)



**GLASSEXCEL**  
architecture hardware



## SS Friction Stay Hinge



Available Sizes: 8", 10", 12", 14", 16", 18", 20", 24"

## Aluminium Door & Window Handle



**DOSSIL-01**  
Casement Handle



**DOSSIL-03**  
Sliding Handle



**DOSSIL-04**  
Casement Handle (Small)

## Self Tapping Screws



## Vacuum Lifter



**DVL-1C**  
Glass Lifter with Two Cups



**DVL-2C**  
Glass Lifter with Two Cups



**DVL-3C**  
Glass Lifter with Three Cups

## DOUBLE SIDED STRUCTURAL GLAZING TAPE

### Glazing Double Side Tape

- \* Durable, high performance two-sided pressure sensitive acrylic foam tapes.
- \* A high strength, clear, UV resistant double-sided film.
- \* Has high adhesion and shear strength.
- \* Heat and solvent resistant.
- \* A good general purpose, permanent glazing tape.

### Applications:

- \* Bonding glass to metal frames (aluminium panel) in curtain wall systems and commercial windows
- \* Attachment of stiffeners and perimeter clips to architectural panels
- \* Exterior building cladding

### Special Feature

Easy to assemble, no drilling, riveting, welding or screw fastening.  
Excellent seal against water, moisture and dust.  
Quick and easy to apply, saves time, labour costs and greater bonding strength.  
Ideal for bonding to a variety of substrates like most metals, glass, plastics, composites and painted surface.



ADHESIVE	Acrylic
ADHESIVE CARRIER	Acrylic Foam
THICKNESS	1.2mm & 2.0 mm
TAPE COLOR	Grey
LINER	Red PE Film
PACKING	100 rolls per cartoon

\* Customized size available according to specific order.

## Door Closer



## Masking Tape



**DOSSIL** is general purpose paper tape used from wide range of industrial applications like masking, splicing, labeling, building, packaging etc. The product conform to almost all surface and has excellent adhesion and tensile strength, for best result always ensure a clear and dry surface before applying tape and check the suitability of the tape for the intended applications.



German Technology <sup>TM</sup>

# GLASSEXCEL

*architecture hardware*

